

## STAINLESS STEEL IP65 ENCLOSURE

### Features:

- 2-4 Single Cells
- Independent Potentiometers
- Captive Stainless Steel Screws

### Options:

- Expansion Port and Lightning Protection
- Signal or Excitation Trim
- FM, ATEX, IECEx Approved

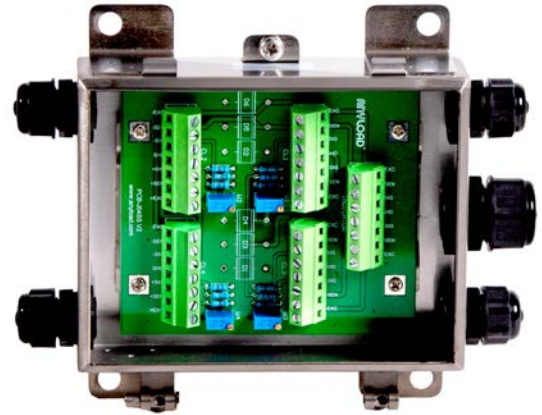

## Drawings

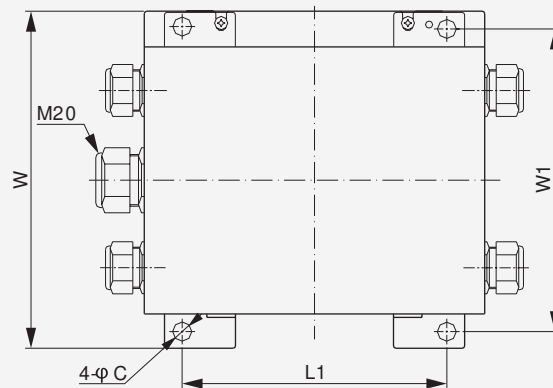
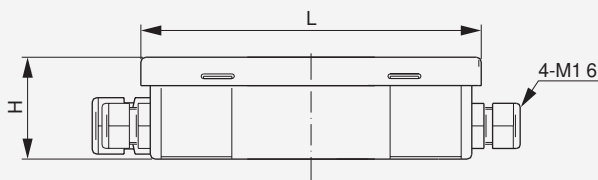

## Dimensions (inches)

Units	C	H	L	L1	W	W1
inches	0.3	1.7	5.7	4.4	5.6	5.0
mm	8	44	144	112	142	128

## STAINLESS STEEL IP65 ENCLOSURE

### Features:

- 2-4 Single Cells
- Independent Potentiometers
- Captive Stainless Steel Screws
- Fits in FSP Floor Scales (smaller enclosure than J04SS)

### Options:

- Signal or Excitation Trim
- FM, ATEX, IECEx Approved

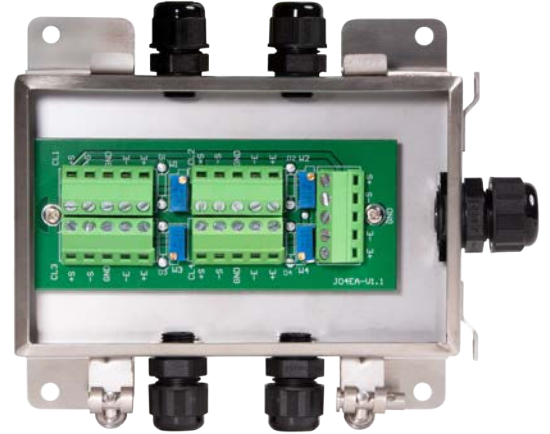

## Drawings

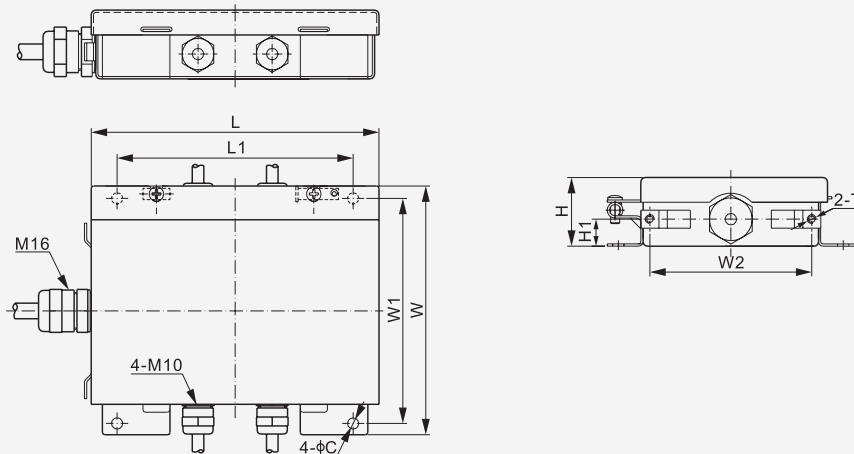

## Dimensions (inches)

Units	C	H	H1	L	L1	W	W1	W2	T
inches	0.2	1.2	0.5	5.0	4.1	4.4	3.9	2.8	M4
mm	5.0	31.0	12.0	128	105	110.5	100	72	M4